

## WBA-100 BOX REPLACEMENT PARTS

Ref.	Part No.	Description	Qty.
1	WBA-3ECOM	BOX ASSEMBLY LESS TOP	1
2	WBA-52AAS	LADDER ASSEMBLY	1
3	WBA-80BAS	CHAIN	6
4	WBA-60A	CHUTE	1
5	CTK0200032	1/8" X 1" COTTER PIN	2
6	HHS0616016	3/8" X 1" BOLT	44
7	HFN0616	3/8" NUT	24
8	HTN0616	3/8" LOCK NUT	44
9	FWW06	3/8" FLAT WASHER	88

### WW-375

Ref.	Part No.	Description	Qty.
*10	WBA-170AAS	10" BOX TOP SIDE ASSEMBLY	2
*11	WBA-171	10" BOX TOP END	2
*12	WBA-172	10" TOP EXTENSION CORNERS	4

### WW-425

Ref.	Part No.	Description	Qty.
*10	WBA-70AAS	18" BOX TOP SIDE ASSEMBLY*	2
*11	WBA-71	18" BOX TOP END*	2
*12	WBA-72	18" TOP EXTENSION CORNERS*	4

### DECAL KIT

Ref.	Part No.	Description	Qty.
	DEC-WBAK	COMPLETE KIT	-
	DE-WBA1	SHORT	3
	DE-WBA2	MEDIUM	1
	DE-WBA3	LONG	4
	DE-WBA4	"W" LOGO	3
	DE-SMV	SLOW MOVING VEHICLE SIGN	1

**NOTE:** \*Refer to WW-375 OR WW-425.

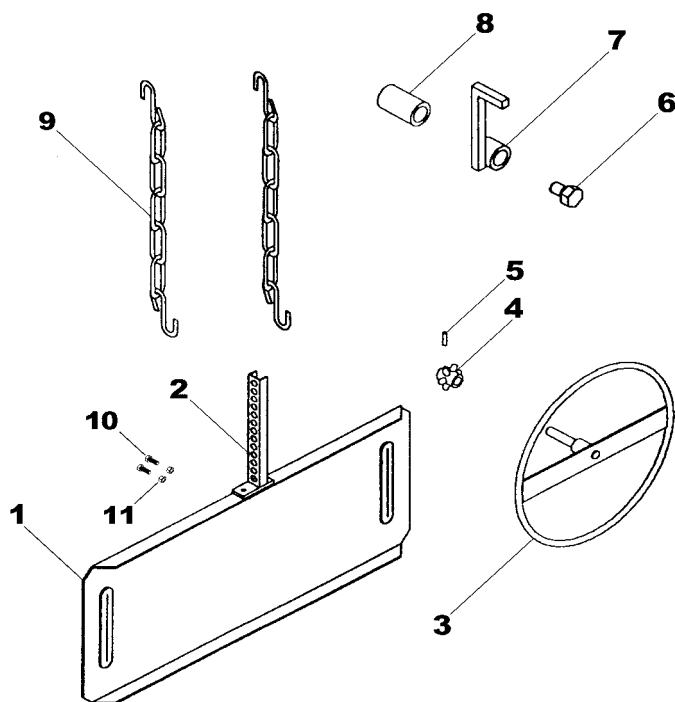

## WBA-100 DOOR PARTS

Ref.	Part No.	Description	Qty.
1	WBA-27	DOOR	1
2	WBA-28AAS	DOOR LIFT CHANNELASSEM.	1
3	WBA-35AS	HAND WHEEL ASSEMBLY	1
4	WB-55	DOOR CASTING	1
5	RLP0500020	5/16" X 1-1/4" ROLL PIN	1
6	HHS1011016	5/8" X 1" BOLT	1
7	WBA-31AS	DOOR LOCK ASSEMBLY	1
8	WBA-30	LOCK BUSHING	1
9	WBA-85AS	CHUTE CHAIN	2
10	HHS0616016	3/8" X 1" BOLT	2
11	HTN0616	3/8" LOCK NUT	2

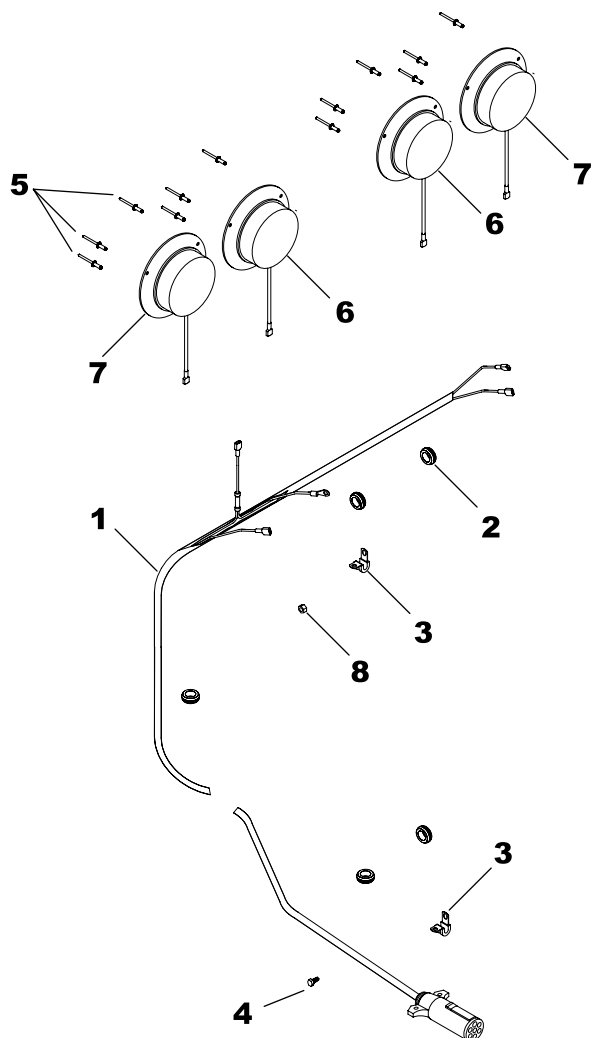

## WBA-100 ELECTRICAL REPLACEMENT PARTS

Ref.	Part No.	Description	Qty.
1	ECB-1BAS	WIRING HARNESS ASSEMBLY	1
2	EC-M01	GROMMET	5
3	EC-M02	CABLE CLAMP	2
4	EC-M03	SELF TAPPING SCREW	1
5	EC-M04	RIVET	12
6	EC-M06AS	RED LIGHT ASSEMBLY	2
7	EC-M08AS	AMBER LIGHT ASSEMBLY	2
8	HFN0420	1/4" NUT	1